

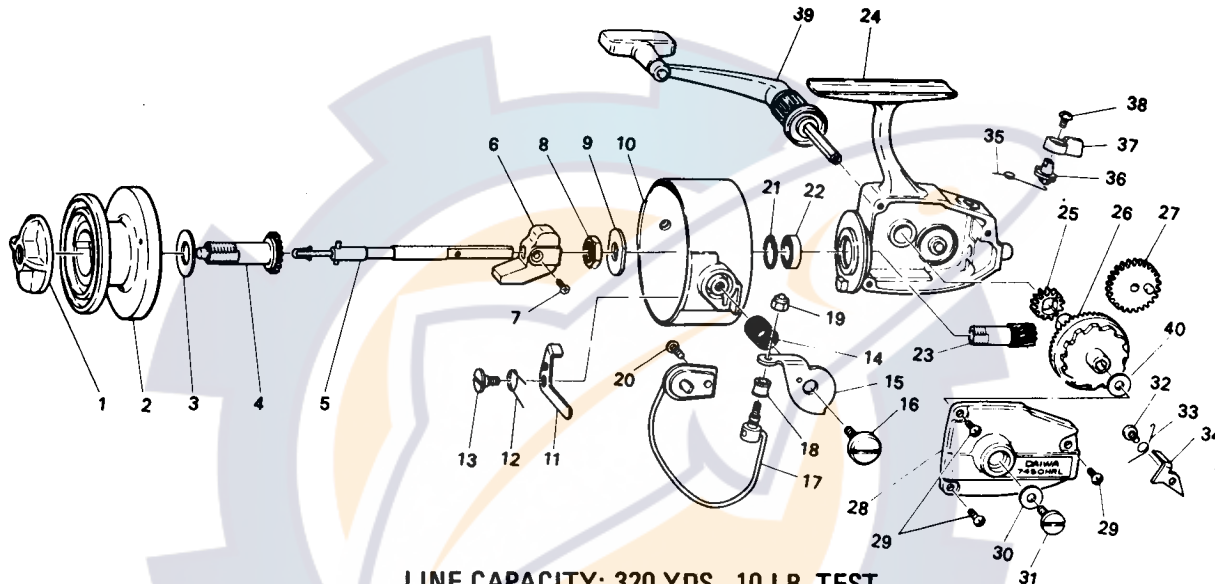

DAIWA

SPINNING REEL 7450HRL

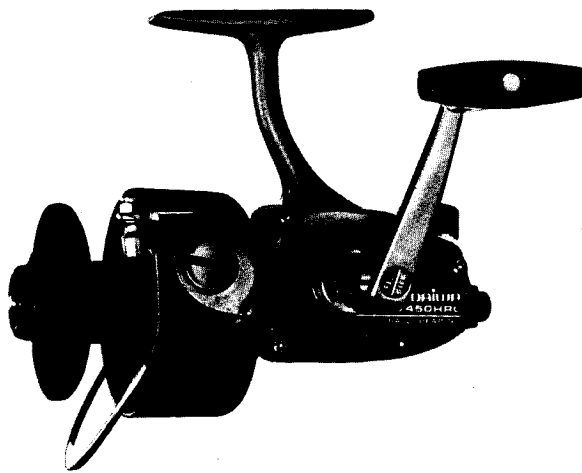

LINE CAPACITY: 320 YDS., 10 LB. TEST

Key No.	Parts No.	Parts Name	Price	Key No.	Parts No.	Parts Name	Price	Key No.	Parts No.	Parts Name	Price	
1	60078414 (A00784)	Drag knob	\$6.50	15	62308301 (2378)	Arm lever	.50	28	60076501 (A00765)	Body cover	\$2.50	
2	60078632 (A00786)	Spool assembly		Sold As One Unit	16	63616611 (36166)	Arm lever screw	.50	29	63521601 (35216)	Body cover screw	.50
3	63731502 (373515-2)	Spool washer			17	60076201 (A00762)	Bail	2.25	30	63724601 (37246)	Handle washer	.50
4	60078561 (A00785)	Spool metal		18	62501901 (2519)	Line roller	.50	31	63515531 (35155)	Handle screw	.50	
5	60076451 (A00764)	Main shaft	1.50	19	63409101 (3491)	Bail nut	.50	32	63501931 (3519a)	Anti-reverse claw screw	.50	
6	64806301 (4863)	Oscillating slider	.50	20	63516401 (35164-1)	Bail holder screw	.50	33	61425411 (14245)	Anti-reverse claw spring	.50	
7	63521501 (35215)	Oscillating slider screw	.50	21	63202911 (3229)	Ball bearing retaining ring	.50	34	61107401 (1174)	Anti-reverse claw	.50	
8	63405842 (3458)	Rotor nut	.50	22	66316901 (63169)	Ball bearing	3.25	35	61422801 (14228)	Anti-reverse cam spring	.50	
9	63729202 (37292)	Rotor retaining washer	.50	23	64013901 (40139)	Pinion	1.25	36	64606821 (4668)	Anti-reverse cam	.50	
10	62010211 (20102)	Rotor	3.50	24	60076141 (A00761)	Body	4.00	37	65403711 (5437)	Anti-reverse lever	.50	
11	65706411 (5764)	Bail kick lever	.50	25	64013701 (40137)	Oscillating pinion	.70	38	63501931 (3519-a)	Anti-reverse lever screw	.50	
12	61425321 (14253)	Bail kick lever spring	.50	26	64120211 (41202)	Drive gear	2.00	39	60076653 (A00766)	Handle	4.50	
13	63612901 (36129)	Bail kick lever screw	.50	27	64014801	Oscillating gear	.80	40	63705150 (3751-d)	Drive gear washer	.50	
14	61409221 (1492-a)	Bail spring	.50									

ALWAYS SPECIFY MODEL NO., PART NAME & PARTS NO. WHEN ORDERING PARTS
PLEASE ENCLOSE CORRECT AMOUNT FOR PART'S PRICE WHEN ORDERING